

# Instruction manual

## Level control

### LL101TE/TES & ELF/ELFS

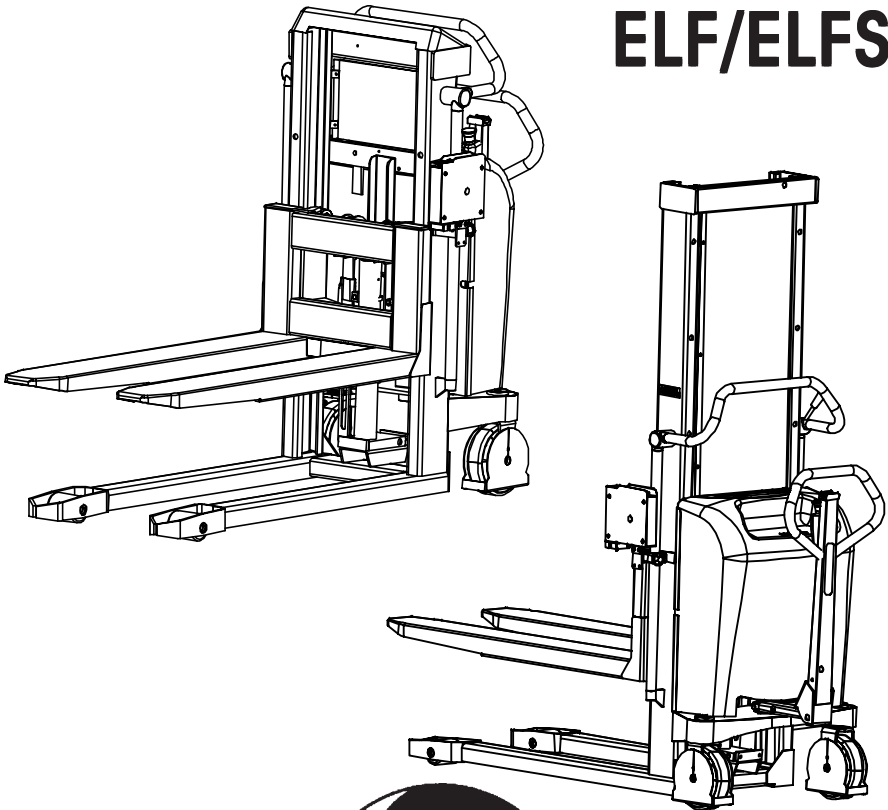

# LOGITRANS

[WWW.LOGITRANS.COM](http://WWW.LOGITRANS.COM)

# 1.0 Before the first lift...

## Safety instructions

The operator must stand so that he or she always has a full view of the lifting and lowering movements of the equipment.

Clearances around the equipment must be checked before operating. No extraneous objects must be placed under the equipment. **MAKE SURE** that neither fork nor load snag extraneous objects during lifting and lowering.

See also the Logiflex / Logilift instruction manual.

If the operator does not have a full view of the Logiflex / Logilift and its lifting and lowering movements, barriers must be placed around the area in which the equipment operates.

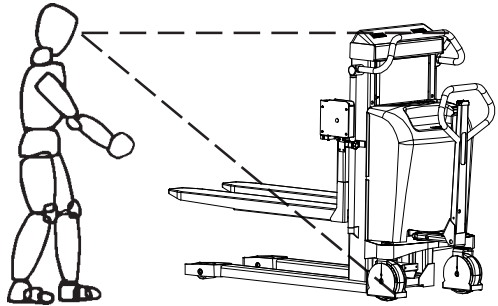

A warning label with the below text must be attached to the Logiflex / Logilift:  
*Black lettering on yellow background:*

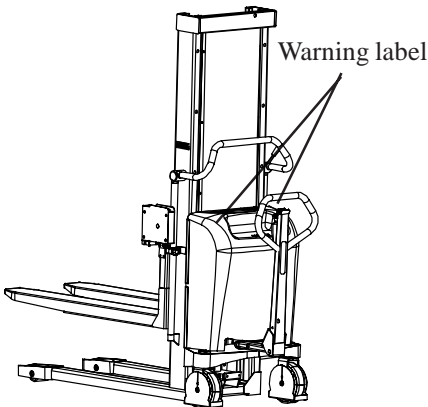

**Remote controlled  
lifting equipment**

Labels must be placed on the  
Logiflex / Logilift  
as shown here.

## 2.0 Operating and functions

1



The brake must be activated before the equipment can be used.

2



Push ON

Logiflex / Logilift can start lifting/lowering



3



Manual operating on the handle is not possible when level control is active

4

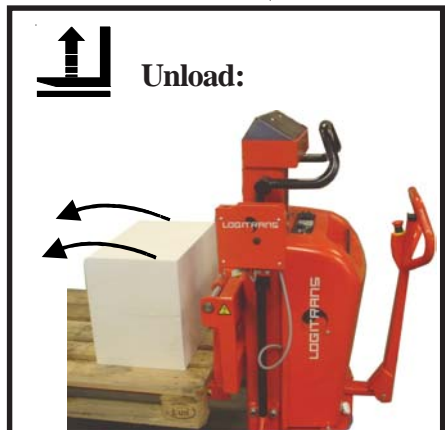
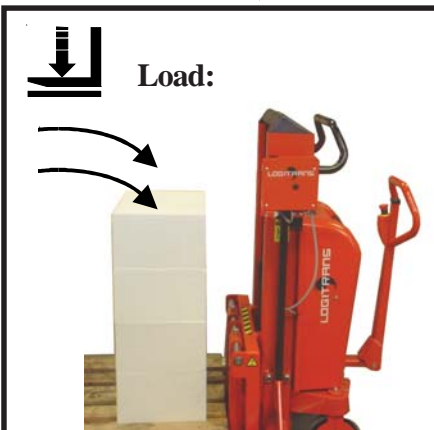

### 3.0 Time delay

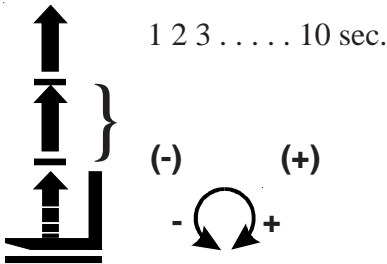

0-10 seconds' delay of lifting/lowering operation.

### 4.0 Function range

The function range is between 550 mm and 920 mm.

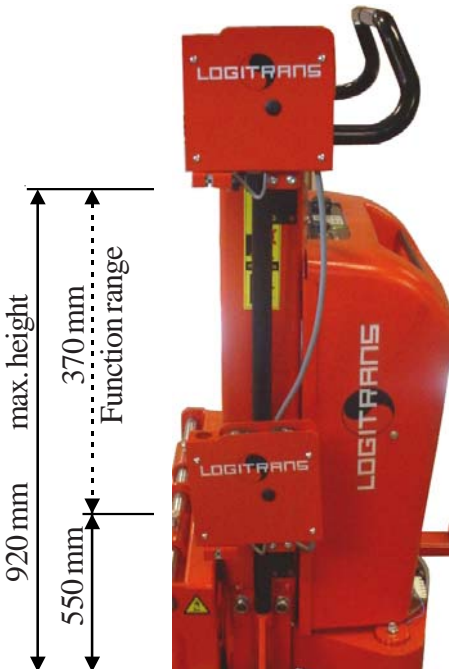

Adjustment of function range.

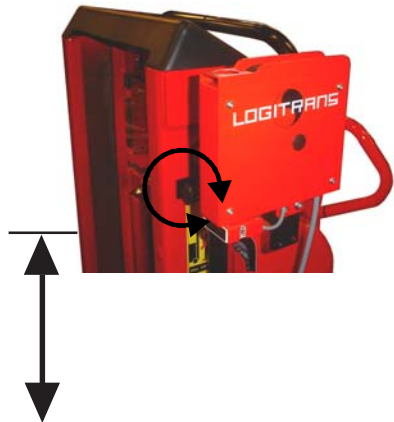

## 5.0 Photocell

The detection range of the photocell can be adjusted up to 1000 mm for white items and 800 mm for black items. The shortest range is approx. 200 mm for white items.

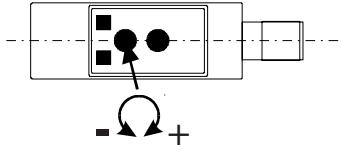

Adjustment of the detection range  
(of the photocell)

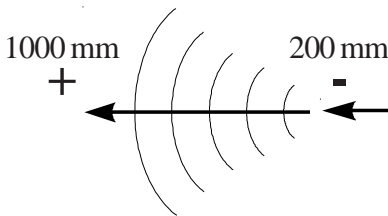

The photocell can be turned 30° to the right or left.

**NOTE!** The cell must point across the pallet.

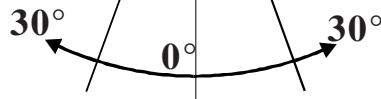

## 6.0 Battery condition

NB! To get optimum function of the equipment, battery charge should not be below 25%.

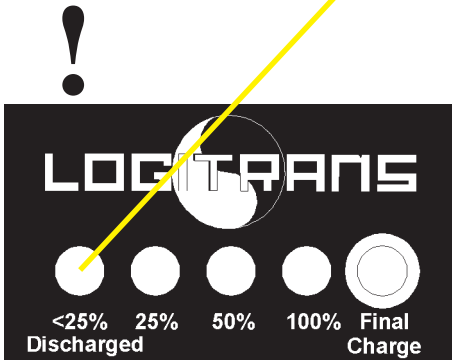

## 7.0 Optional side mounting

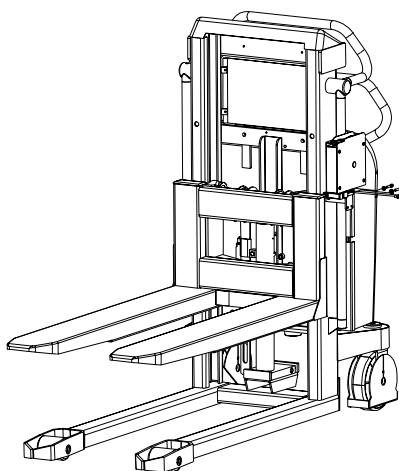

- 2 screws on centre tube
- 2 screws on the control box

Remove 2 x 2 screws

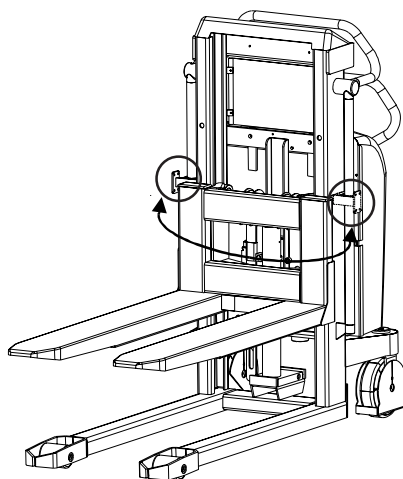

Change the slide to  
opposite hand

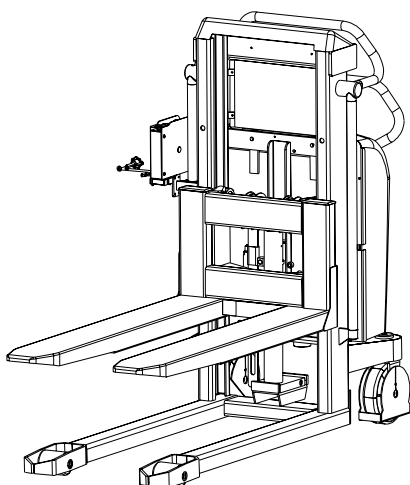

Refit 2 x 2 screws



## 8.0 Adjustment



Adjustment is necessary if the motor does not stop before the top position and the distance between pallet and underlay (or floor) is less than 100 mm.

Adjustment of top and bottom stop for forks

UP= moves up top and bottom stop.

Down = moves down top and bottom stop.

### NOTE!

Overpressure valve must not be activated.

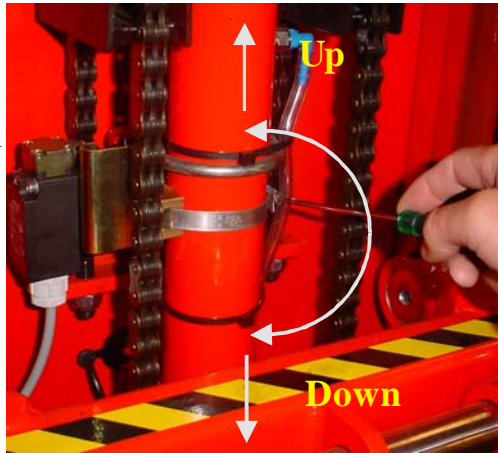

### After adjusting:

### NOTE!

If the distance between pallet and underlay (or floor) is less than 100 mm (Euro-pallet):

Contact the dealer!

NB! Be aware of different pallet types



Min. 100 mm

## 9.0 Replacement of fuse

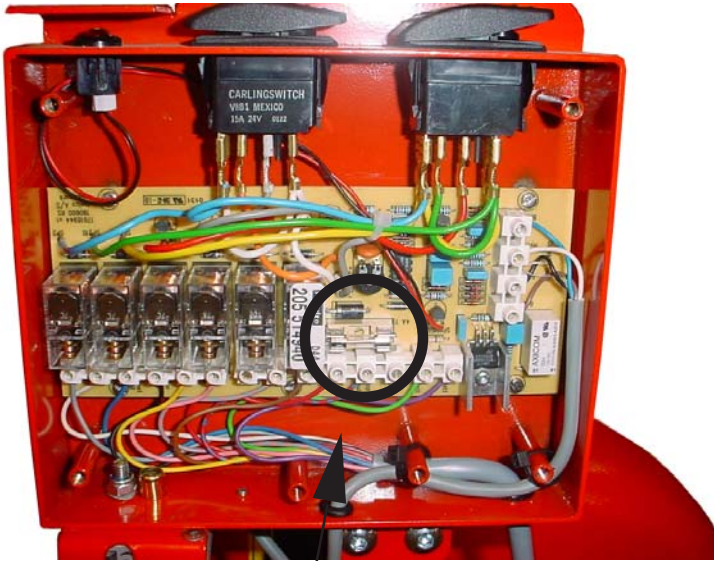

Examine the fuse.

Part number 986066 ( $\phi 5 \times 20$ , 250V 4A T)

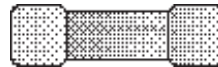

## 10.0 Fault location key

After a certain time, adjustments can be necessary.

**BEFORE CONTACTING THE DEALER FOR HELP....**

**... TRY USING THE FAULT LOCATION KEY!**

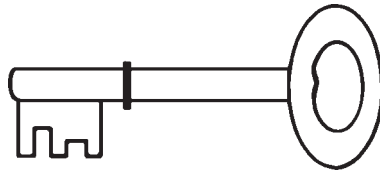

**Symptoms and observations:**

**SWITCHES:**

**A** Lamp works but no reaction.

**B** The lamp does not work and the equipment does not react.

**C SLIDE:**

Does not slide up and down with the forks.

**D PHOTOCCELL:**

Does not react.

**E BATTERY:**

If the battery is low, the level control might react unpredictably and not react to the photocell.

**F BRAKE:**

Does not work or remain in the correct position.

**Cause**

**Remedy**

		Check photocell setting	Contact dealer	
		Check brake and brake switch	Contact dealer	
		Check for cable fracture		
		Examine fuse.	9.0	
		Check for obstructions		
		Check for dirt and uncleannesses on the centre tube		
		Check spring tension in slide		
		Adjust photocell range	5.0	
		Adjust photocell direction across pallet	5.0	
		Check condition of battery	6.0	
		Charge battery	6.0	
		Check that the pedal is pressed as far down as possible	2.0	
A	●			
B		● ● ●		
C			● ● ●	
D				● ●
E				● ●
F		●		●

If the problem cannot be solved by using the fault location key.....

..... please contact your distributor!

### **Periodic safety inspection**

Safety inspection should be performed by the supplier or other qualified persons at least once each year, unless local regulations state otherwise.

Such inspection shall be performed in accordance with the instruction manual. Test instructions and test forms are available from the distributor.