

LFRRM/LFSRRM

S994



EU DECLARATION CONFORMANCE

Manufacturer: **Logitrans A/S**
Hillerupvej 35
DK-6760 Ribe
Denmark

It is hereby declared that:

Machine: Productgroup: Reel Rotator

 Type: LFRRM / LFSRRM

 Year of manufacture/
Serial No:

- a) Has been manufactured in conformance with the stipulations of the:
- **Directive no. 2006/42/EC**
- b) Has been manufactured in conformance with the stipulations of the standard:
- **EN 3691-5**

Name: **Gitte K. Berg**

Position: **CEO**

Company: **Logitrans A/S**

Signature:



Product type declaration of:

16.02.2016



Contents

1.0 Before the first lift...	4
2.0 Functions and identifications	5
3.0 How to operate the Reel Rotator	6
3.1 Handling of reels	6
3.2 The four positions of the release lever	7
3.3 Clamping/fastening of reels	8
3.4 Extra support	10
3.5 Rotation of reels	11
4.0 Optimum safety	12
4.1 Avoid overloads	13
4.2 Safety valve/pressure relief valve	13
4.3 Driving loaded	13
4.4 Rotation with load	14
5.0 Long live Reel Rotator	15
5.1 Lubrication and hydraulic oil	15
5.2 Oil change	15
5.3 Replacement of valve insert(s)	16
5.4 Seal leakage	16
5.5 Valve cone does not seal completely	16
5.6 Adjustment of steering wheel chains	17
5.7 Cleaning	17
5.8 Adjustment of the valve control system	18
5.9 Adjustment of reel carriage	19
5.10 Adjustment of lifting chain	19
5.11 Adjustment of side play	20
6.0 Good service after purchase	21
6.1 Ordering spare parts	21
6.2 Warranty/Compensation	21
6.3 Service and repair	21
6.4 Warranty	21
6.5 Liability exemption	21
7.0 Fault location key	22





1.0 Before the first lift...

The **Reel Rotator** is manufactured in accordance with safety directives.

Among the subjects dealt with in this **Instruction Manual** are:

- Proper application
- Physical limitations of the product
- Risks with improper use

Therefore please read this **Instruction Manual** carefully!

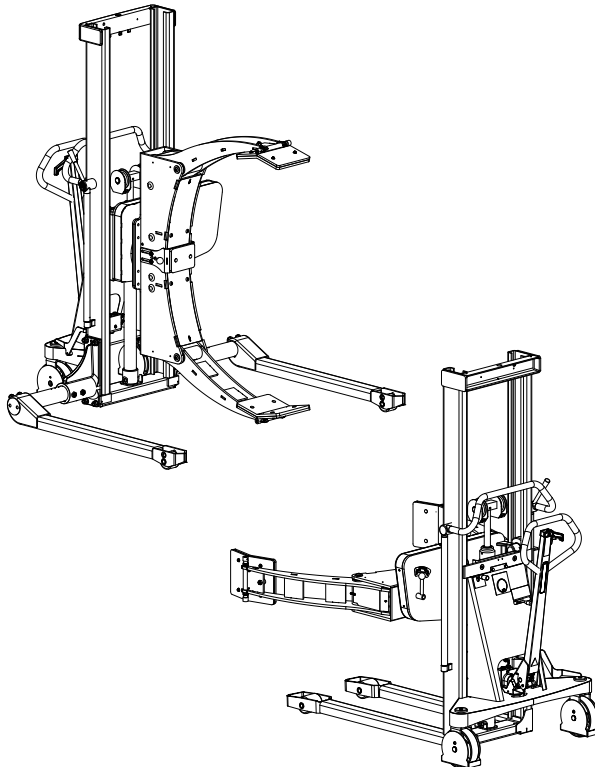



2.0 Functions and identifications

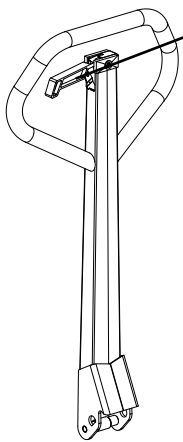

The four positions of the release lever:

- Lowering / opening gripping arms
- Neutral
- Normal lift / -fastening gripping arms
- Quick lift / -fastening gripping arms

Released position

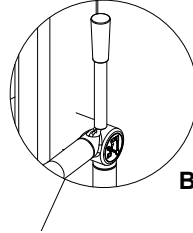

Braked position

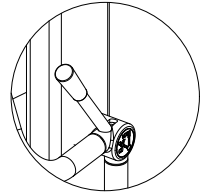

To release the brake:

1. Pull
2. Push

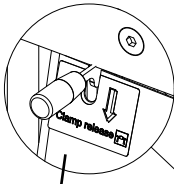

Operation by two hands is required to release the reels

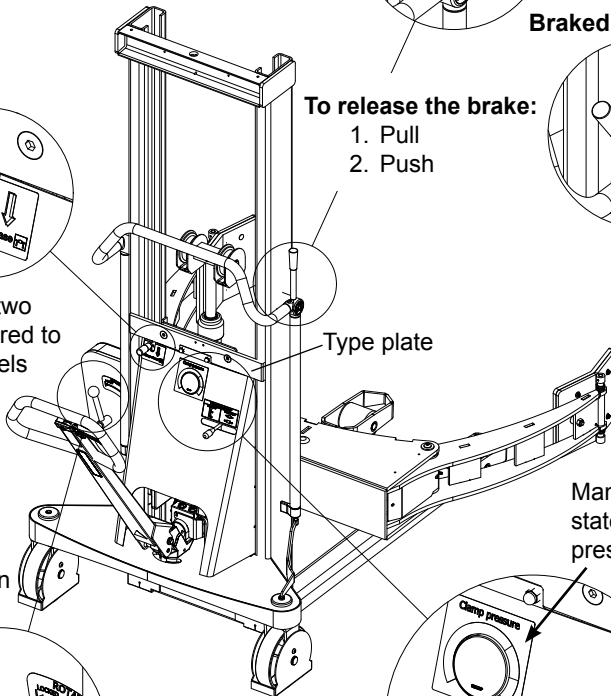

Type plate

Manometer states the clamp pressure

Handle to enable rotation

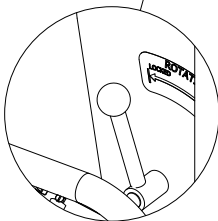

“Function selector” to shift between “Raise/Lower” and “Clamp/Release”





3.0 How to operate Reel Rotator

3.1 Handling of reels

LFSRRM

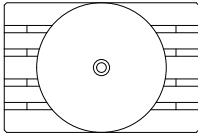
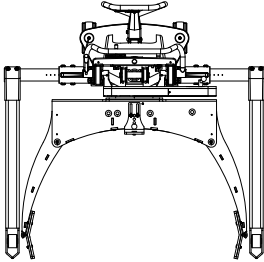

Handling of reels on closed pallets
- use the Reel Rotator with straddle legs!

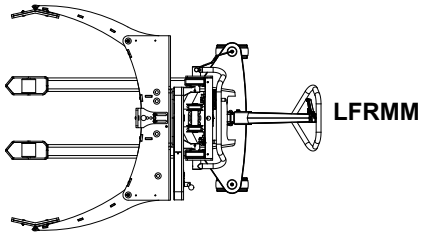

3.0 How to operate Reel Rotator

3.2 The four positions of the release lever

1. Lowering / opening gripping arms
2. Neutral
3. Normal lift / -fastening gripping arms
4. Quick lift / -fastening gripping arms

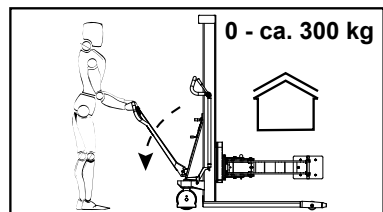
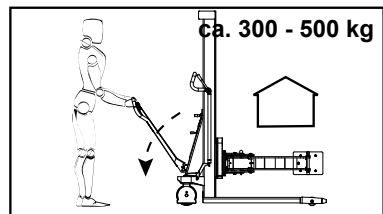
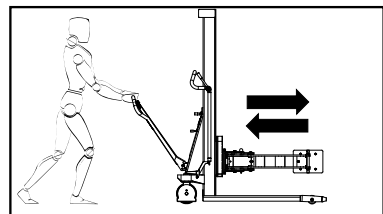
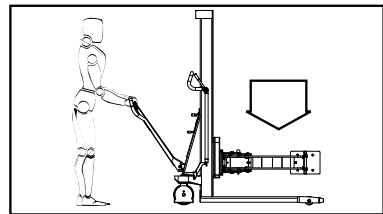
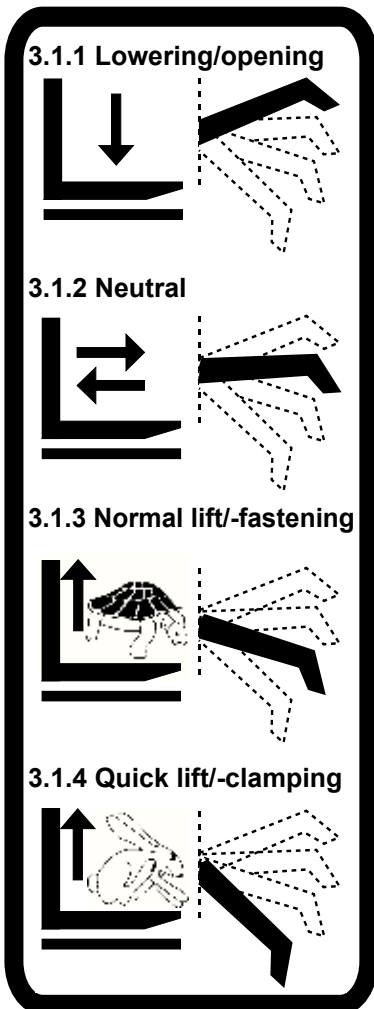

3.0 how to operate Reel Rotator

3.3 Clamping/fastening of reels

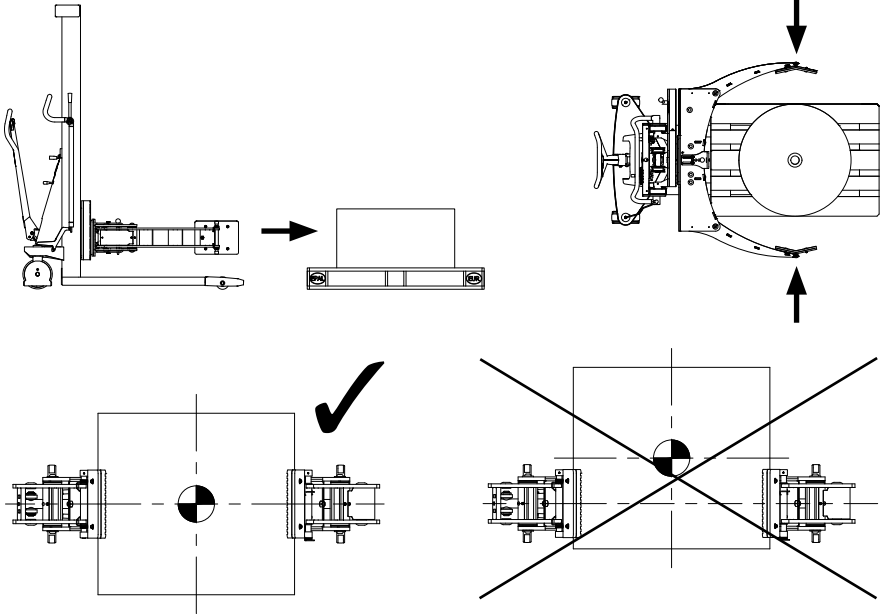

3.0 How to operate Reel Rotator

Clamping/fastening of reels (continued):

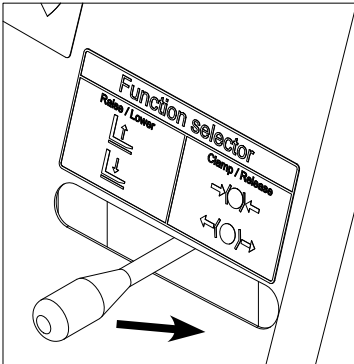

Place the "Function selector" in position "Clamp/Release"

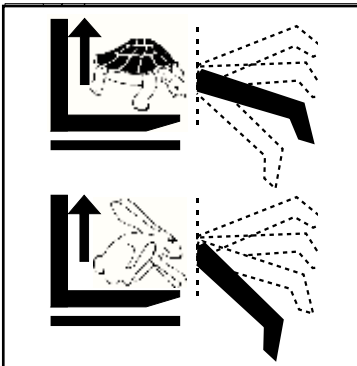

Normal lift/-fastening of reels

Quick lift/-fastening of reels

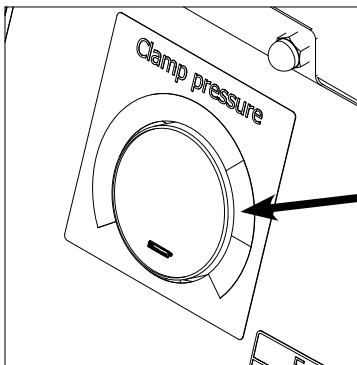

Pump until the manometer is in the "green area"

3.0 How to operate Reel Rotator

Opening gripping arms:

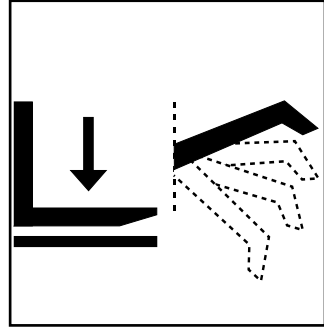
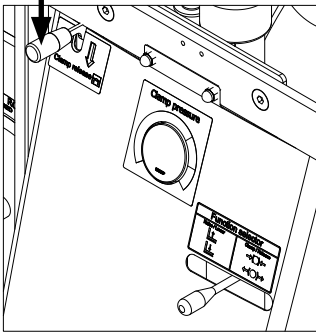

Press down the handle for “Clamp release” and at the same time place the release lever in position “Lowering”

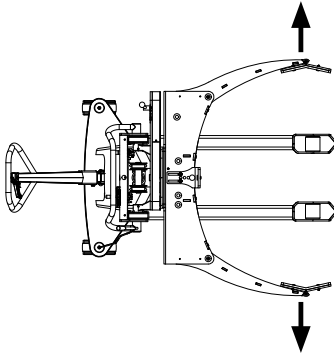

Note!

As a safety precaution, the gripping arms can only be opened, when the lifting system is without pressure.

3.4 Extra support

For reels from Ø800mm to Ø1270mm it is possible to use three-points clamping.

By adjusting the shown supporting plate, so that it supports the reel, it can be prevented that the reel moves between the two plates that primarily fasten the reel.

The supporting plate can also be set as stop for a certain reel diameter.

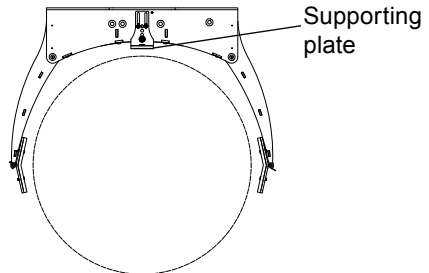

3.0 How to operate the Reel Rotator

3.5 Rotation of reels

Check that the load is placed in the load center before rotating (see points. 3.3)

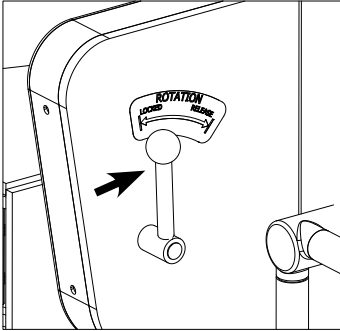

Press handle to position "Release"

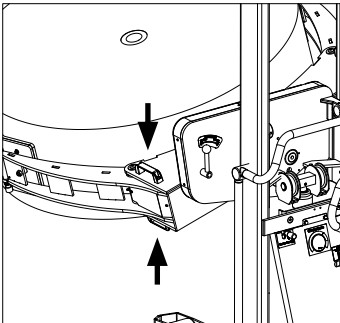

The reel carriage can now be rotated by the gripping handles.

The reel carriage can be locked for each 90°.



4.0 Optimum safety

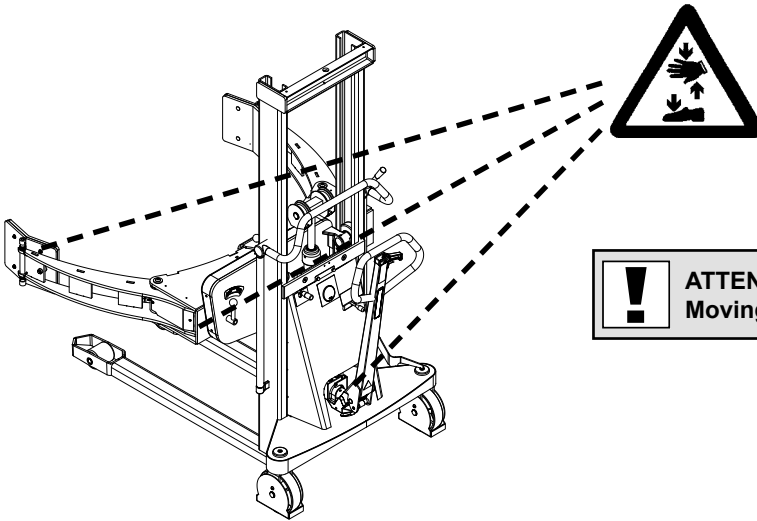

Safety regulations

- Never walk under a raised load
- Never stand between the gripping arms
- Before lowering the reel carriage, make certain that no foreign elements can hinder the free lowering of the the reel carriage
- The Reel Rotator is designed for use on an even and level floor
- During transport the reel carriage shall be raise as little as possible
- Transport with raised reel carriage should be made over the shortest possible distances and at low speed
- Check that the chains lift equally. They shall be equally tight when the reel carriage is loaded
- Chains and chain bolts must not be damaged. Chains that have become permanently stretched (max. 2% of original length) must be scrapped.

4.0 Optimum safety

4.1 Avoid overloads

The maximum load must not be exceeded.

4.2 Safety valve/pressure relief valve

The pressure relief valves on the Reel Rotator are factory set for the maximum design load (**500 kg**). The setting protects the Reel Rotator from overload so that it cannot be damaged by the inadvertent lifting of loads being too heavy.

- If the pressure relief valve is defective, replace the entire valve insert.

When a valve insert is ordered from a dealer, replacement instructions accompany the replacement part.

4.3 Driving loaded

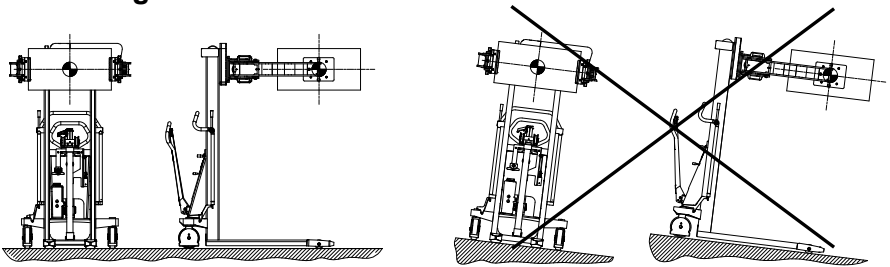

The Reel Rotator is designed for use on even and level floor. During transport the reel carriage shall be raised as little as possible. Transport with raised reel carriage should be made over the shortest possible distances and at low speed.

4.0 Optimum safety

4.4 Rotation with load

Note! Rotation is only allowed to take place, if the Reel Rotator is placed on an equal floor.

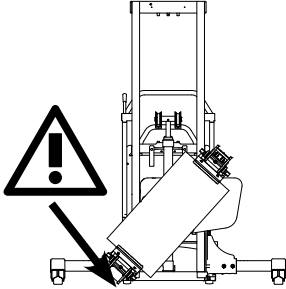

When rotating reels, the operator needs a full overview of the whole working area, so that the rotation movement can be stopped before the reel touches the floor, the items or persons in the working area.



5.0 Long live Reel Rotator

Regular inspection and the replacement of worn or defective parts in good time will prolong the life of the Reel Rotator. "Prevention is better than repair", therefore ensure:

- Correct usage
- Regular cleaning
- Periodic safety and service inspection
- For safety reasons please check the below every 3 month:
 - Tighten loose screw and nuts
 - Check that there are no cracks, fractures and deformations in the bearing construction
 - Wearing parts, such as brakes, wheels and bearings, are adjusted and exchanged continuously

5.1 Lubrication and hydraulic oil



Under normal operation conditions the Reel Rotator requires no lubrication. All ball bearings are sealed and lubricated for life and moving parts have self-lubricating bearings or are treated with grease. The hydraulic system is filled with hydraulic oil of the viscosity class ISO VG 10. An additive is added to the oil.

The concentrate reduces friction and wear and protects against corrosion. Pre-mixed hydraulic oil with additive is available from the dealer. The oil is suitable for use in the temperature range -10 to +50° C. A thinner oil is recommended for temperatures lower than -10°C (if necessary, contact your dealer).

5.2 Filling in oil

1. Bring the unloaded reel carriage down to the lowest position with open gripping arms.
2. Take off the rear cover.
3. Take off the filling cap and fill in the oil (no further than approx. 5 cm from the top of the tank).
4. Oil quantity:
LFRRM 1750 & LFSRRM 1750 approx 2,6 liter
5. Be aware that the suction hose is placed minimum 2 mm above the bottom of the tank.

5.0 Long leve Reel Rotator

5.3 Replacement of valve insert(s)

If all fault remedy possibilities (see fault location key, point 7.0) have been tried without satisfactory results, the entire valve insert must be replaced.

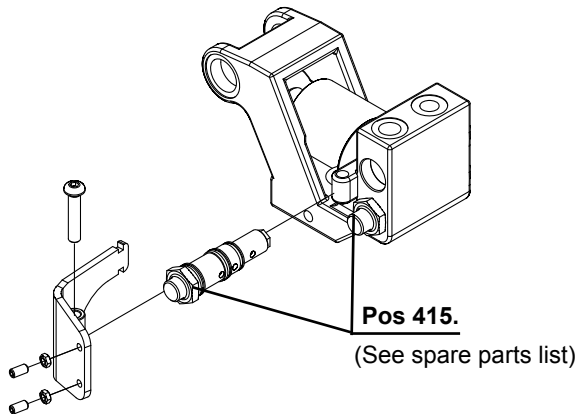

When a new valve insert is ordered from a dealer, **replacement instructions** accompany the replacement part. Therefore order before replacing!

After replacement, adjust the oil quantity in the tank, as described under **Filling in oil** (point 5.2).

5.4 Seal leakage

Locate the point at which oil leakage appears and then replace defective seals.
(See spare parts list).

5.5 Valve cone does not seal completely

Pump quickly a few times so that oil quickly flows over the valve cone (best with a small load).

If this does not solve the problem, the valve insert must be replaced by a new one.
(Replacement instructions accompany the new valve insert).

5.0 Long live Reel Rotator

5.6 Adjustment of steering wheel chains

- Set the handle in its middle position
- Adjust the nuts (1,2 3 and 4) and bring the wheels into parallel.

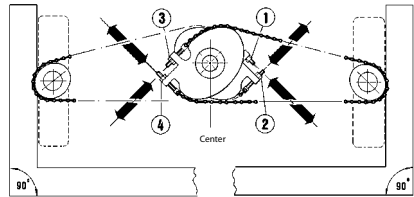

5.7 Cleaning



When cleaning the Reel Rotator, do not direct the jet onto bearings and seals. Otherwise the grease will be washed out and the life of the equipment shortened.

Cleaning of the plastic screen (polycarbonate)

The screen is to be washed with slightly warm water added a neutral cleaning material, and afterwards washed with clean water.

Use a soft sponge, a woollen cloth or a wash leather.



Never use sharp objects or solvent cleaners when cleaning.

5.0 Long live Reel Rotator

5.8 Adjustment of the valve control system

Procedure: Release arm with two adjusting screws.

Both adjusting screw "C" and adjusting screw "D" have to be turned, so that they do not touch the valves.

1. Place the release lever in the quick lift position. Press screw „E“ and tighten, until the adjusting piece does not touch the cutting of the handle.
2. Place the release lever in the normal lift position. Fasten the top adjusting screw „C“, until the pump movements get easy. When the position has been found, turn (tighten) further $\frac{1}{4}$ turn. Counter nut C1 is tightened finally.
3. Place the release lever in the neutral position. Tighten the bottom adjusting screw „D“, until no lifting is performed by the pump movements of the handle. When the position is found, tighten further $\frac{1}{4}$ turn. Counter nut D1 is tightened finally.

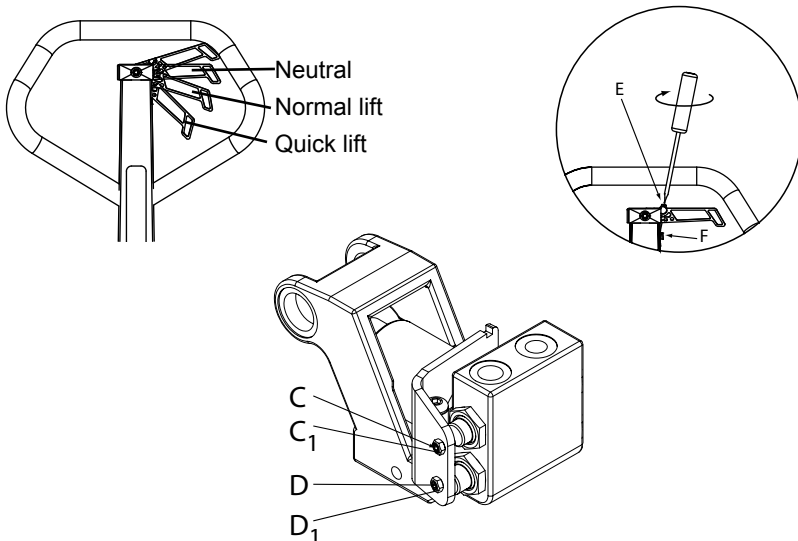

5.0 Longe live Reel Rotator

5.9 Adjustment of the carriage

Two of the rollers on the carriage are mounted on eccentric pins, so that they can be adjusted. The adjustable rollers are at the top.

1. Loosen screw (pos. 91) (key width 5 mm).
2. Eccentric pins (pos. 56) (key width 8 mm) can now be turned to give the necessary adjustment of the carriage.
3. Adjustment must be made on both sides to ensure uniform loading of the rollers.

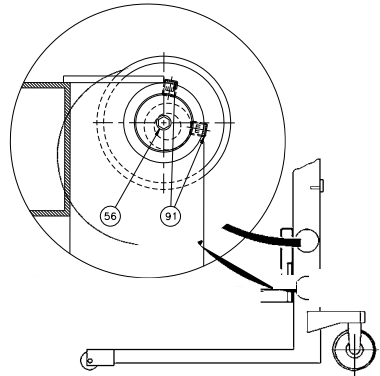

5.10 Adjustment of lifting chain

The chains shall be adjusted so that

- they lift equally
- they are equally tight
- The lifting movement has to stop in the cylinder, before the mast rolls touch the top stop.

The nuts (pos. 18) are to be adjusted (nut M12, key width 19 mm).

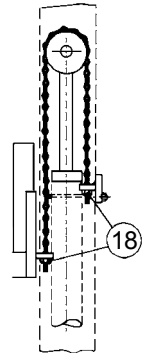

5.0 Longe live Reel Rotator

5.11 Adjustment of side play

(In the mast rolls of the right side of the carriage)

- 1: Screw (A) is loosened counter-clockwise, until resistance disappears.
- 2: Turn the screw clockwise, until resistance appears. The following 1.5 to 2.5 turns of the screw will be a tightening of the spring (C).
- 3: When a larger resistance appears, make 0.25 turn counter-clockwise, and the counter nut (B) will be tightened.
- 4: Pump the carriage to its top position, and when lowering it has to slide to the bottom. If this is not the case, loosen screw A, make c. 0.5 turn counter-clockwise and repeat point 4.

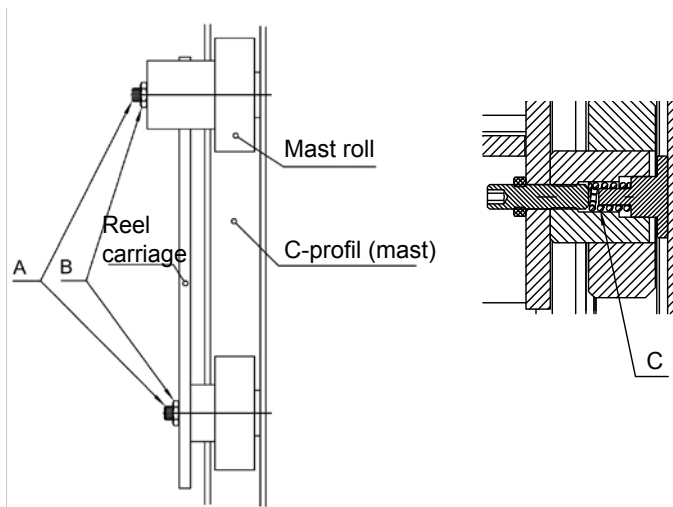



6.0 Good service after purchase

6.1 Ordering spare parts

The correct spare parts are obtainable from your dealer.

When ordering, please state:

- Serial number of the product
- Type and width/length of the product
- Spare part no. Please find spare part no. on www.logitrans.com.

6.2 Warranty/Compensation

Spare parts delivered during the warranty period will be invoiced. A credit note will be sent immediately after we have received and tested the defective parts and found that the warranty conditions have been met.

6.3 Service and repair

You should be able to make adjustments and perform minor repairs on the spot. However, major repairs should be left to the dealer who has well-trained personnel and the necessary special tools.

6.4 Warranty

The warranty covers material and assembly defects which, subject to inspection by us or our representative, are deemed to be faults or deficiencies that prevent normal use of the parts concerned. Such affected parts shall be sent to your Logitrans dealer carriage paid within the warranty period in force at the time in question, together with a copy of the documentation for the service performed (B284 - see the back page). The warranty does not cover normal wear and adjustments.

The warranty period is based on singleshift working.

The warranty shall no longer apply if

- the product has been used incorrectly,
- the product is used in environments for which it was not designed,
- the product has been overloaded,
- replacements of parts have been made incorrectly or original parts have not been used and consequential damages have arisen,
- if the product is changed or accessories, not being approved by Logitrans, are used,
- it can not be proved that a qualified technician has performed the service check-according to the requirements stated in the instruction manual (see the back page).

6.5 Liability exemption

The manufacturer accepts no responsibility for personal injury or material damage arising from deficiencies, defects or improper usage. The manufacturer accepts no responsibility for lost earnings, operating losses, lost time, lost profits or similar indirect losses incurred by the purchaser or a third party.



7.0 Fault location key

When the Reel Rotator is used every day, adjustments and the replacement of worn parts might be necessary.

Adjustments and minor repair can easily be made on the spot. Major repairs should, however, be carried through by the dealer who has a well-trained staff and the necessary special tools.

	Before asking the dealer for assistance... ...try the fault location key!
--	--

Symptoms and observations

- A** The reel carriage move up and down with pump strokes _____
- B** The Reel Rotator does not lift to maximum height _____
- C** The load is difficult to pump with the handle in its normal position _____
- D** The reel carriage do not lift quickly when the handle is placed in its quick position _____
- E** The reel carriage cannot be lowered _____
- F** The reel carriage lowers after being raised _____
- G** The reel carriage cannot be raised by repeated pumping attempts _____
- H** The reel carriage does not raise at the first pump stroke, or the pump does not operate in the whole pump stroke _____
- I** The pump does not react when changing over the release lever (sluggishness) _____
- J** The reel carriage cannot be lowered completely _____
- K** The reel carriage does not lift horizontally _____
- L** The Reel Rotator is unable to lift 500 kg to top position _____
- M** Steering wheel does not drive evenly _____

Cause

Mending

	Load heavier than the max. permissible	See point 4.1
	Oil deficiency	See point 5.2
	Valve control system needs adjustment	See point 5.8
	Seal leakage	See point 5.4
	Valve cone does not seal completely	See point 5.5
	Release pin jammed in control valve	See point 5.3/5.8
	Air in hydraulic system	1. Lift to the top 2. Lower
A	Temperature degrees below zero	See point 5.1
B	Reel carriage needs adjustment	See point 5.9/5.10
C	Pressure relief valve defective	See point 5.3
D	Lowering mechanism needs adjustment	See point 5.8
E	Steering wheel out of adjustment	See point 5.6
F	<p>If the problem cannot be solved by using the fault location key... ...please contact your dealer!</p>	
G		
H		
I		
J		
K		
L		
M		

Periodic service and safety inspection

Service check is required once each year, or at least for every 250 hours of operation.

Safety inspection should be performed by the dealer or other qualified persons at least once each year, unless local regulations state otherwise.

The inspection is to be performed on the basis of form no. B0342, and proved on form no. B284. Forms and instructions for the inspection are available at your dealer.

S 994

LFRRM-LFSRRM-L-EN
16022016